

INSTALLATION MANUAL:

COR-4109010

JEEP FRONT AXLE DISCONNECT SKID

2018+, JL/JT



INCLUDED ITEMS

4109010 Jeep Wrangler Front Axle Disconnect Skid Plate (2018+, JL)

QTY	Part Number	Description	Class/Grade	ID Number
1	4109010A	Jeep Wrangler FAD Skid Plate Bracket	N/A	1
2	0141407	M8-1.25 x 30mm Hex Drive Steel Flat Socket Cap Screw	Class 10.9	2
1	N/A	Cable Tie	N/A	3

Product Notes and Features:

- 1/4" thick steel construction engineered using advanced CAD software and modern manufacturing techniques.
- Shields the front axle disconnect from impacts caused by rocks and other obstacles from both the front and rear.
- Features a bolt-on design with six secure mounting points
- Countersunk hardware where it matters prevents unnecessary wear and tear
- Allows easy access to the lower control arm bolt, even with the skid plate installed, making installation and retorquing simple

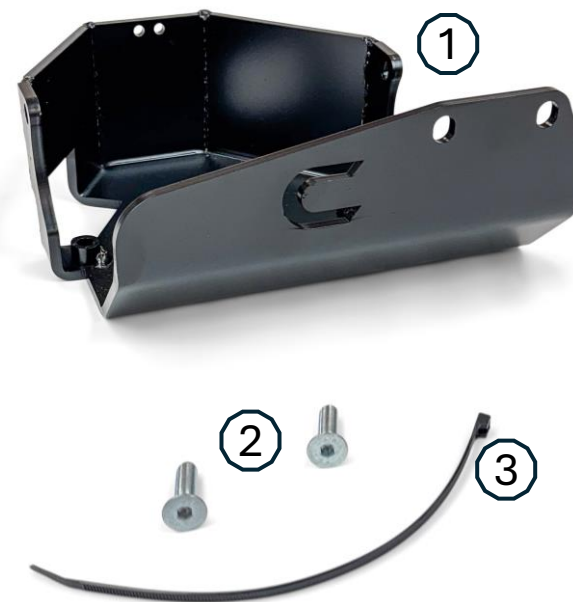

Note: This installation requires removing the factory steering stabilizer mounting location. Before completing this installation, plan to replace the factory stabilizer mounting points.

ATTENTION!

For optimal results, it is highly recommended to install the COR-5209011 Jeep Wrangler Steering Stabilizer Relocation Bracket Kit (2018+, JL) before beginning the installation of this skid plate.

Please note that removing the factory steering stabilizer mounting points is required for this installation. The COR-4109010 skid plate has been tested and proven to work seamlessly with the COR-5209011 bracket kit. While other aftermarket steering stabilizer brackets may also be compatible, Clayton Off Road cannot guarantee their fitment.

COR-5209011 Steering Stabilizer Bracket Kit



COR-5200940



COR-5209010

INSTALLATION INSTRUCTIONS

TOOLS REQUIRED FOR INSTALLATION

- Basic hand tools
- Metric wrench/socket set, 10mm, 13mm

*****Take this product to a licensed professional if you are hesitant about the installation process!*****

1. Position the vehicle on flat ground. This product can be installed without a lift or jackstands.

Remove the factory FAD skid plate located on the backside of the axle using a 10mm socket. The factory skid plate is highlighted red in Figure 1, and the (4) 10mm bolts that fasten it are highlighted in blue. Keep all factory hardware unless noted otherwise.

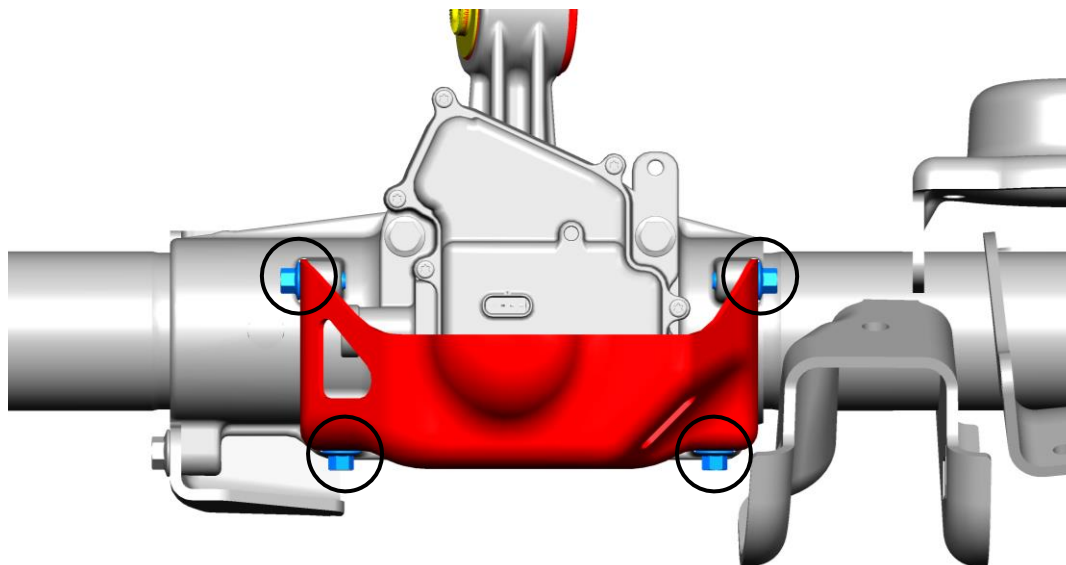

Figure 1: FAD skid plate (red) to be removed

INSTALLATION INSTRUCTIONS

2. Remove the factory axle-side steering stabilizer mount. Use a 13mm socket to remove the (3) bolts highlighted in Figure 2. As stated previously in these instructions, relocation of the steering stabilizer is necessary to complete this installation. Keep all factory hardware unless noted otherwise.

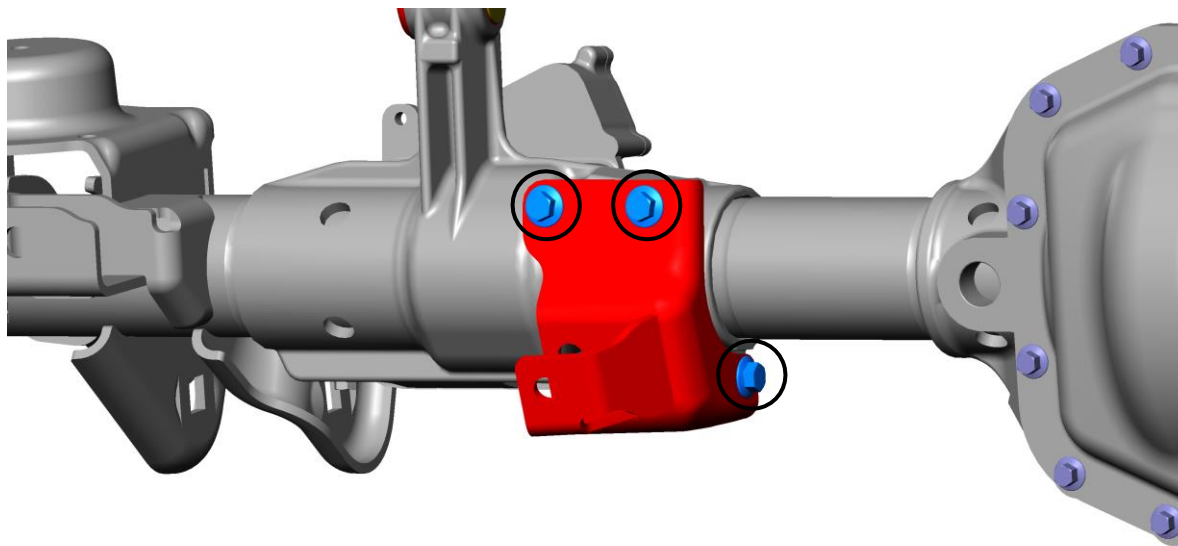

Figure 2: Factory axle-side steering stabilizer mount to be removed

INSTALLATION INSTRUCTIONS

- Slip the new FAD skid plate into position on the axle and secure it with the two supplied flathead hex screws. The screw holes are located on the bottom of the skid plate and are highlighted in the figures below. **Do not tighten yet.**

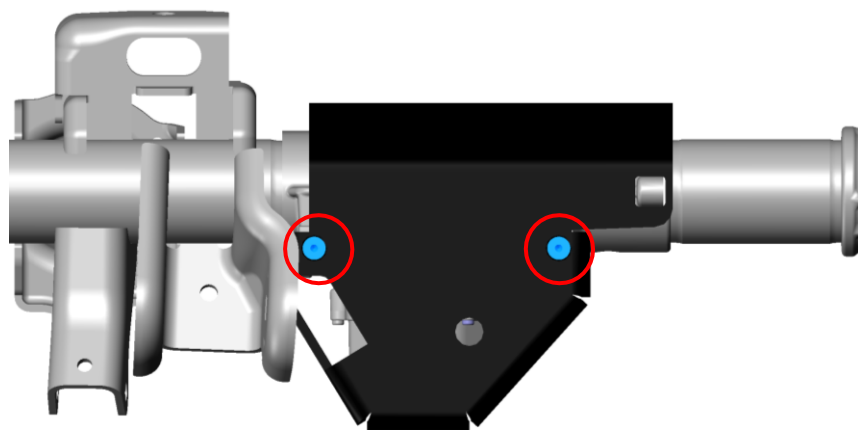

Figure 3: CAD and installation photo of FAD skid plate in position

INSTALLATION INSTRUCTIONS

4. Using a 10mm socket, install the two upper rear factory skid plate bolts on either side of the FAD housing. Secure them through the new skid plate and into the threaded bosses on the axle. Refer to Figure 4, where these bolts are highlighted.

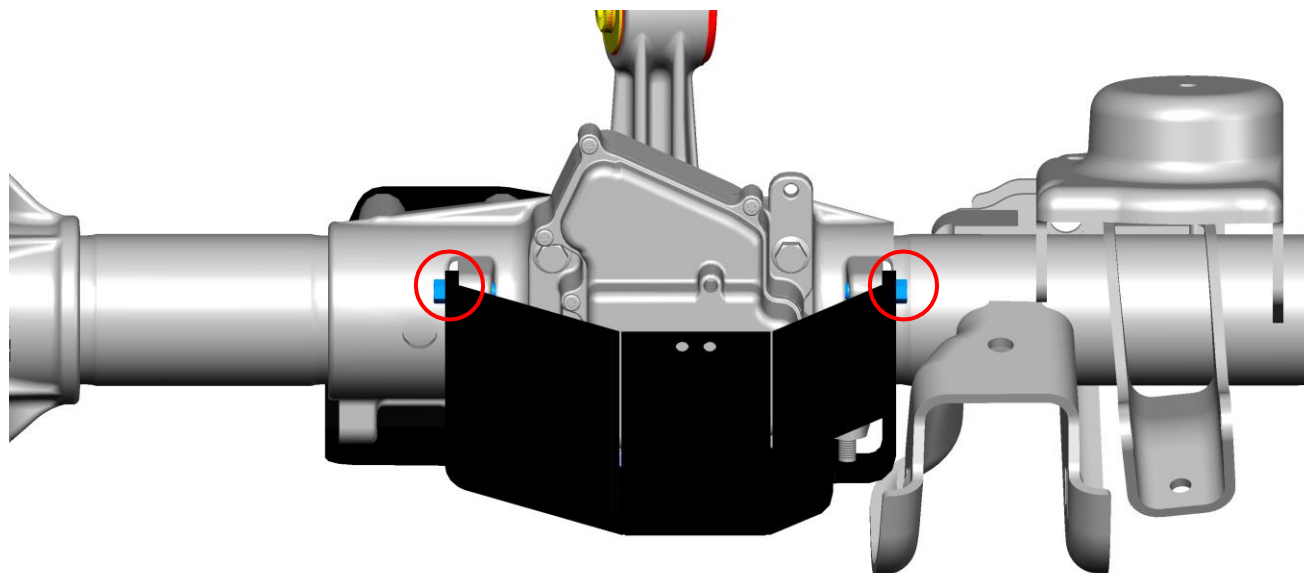

Figure 4: Factory skid plate bolts installed on new FAD skid plate (rear)

INSTALLATION INSTRUCTIONS

5. Using a 13mm socket, install the two front upper factory skid plate bolts on the front of the new FAD skid plate. The bolts are highlighted in Figure 5 below.

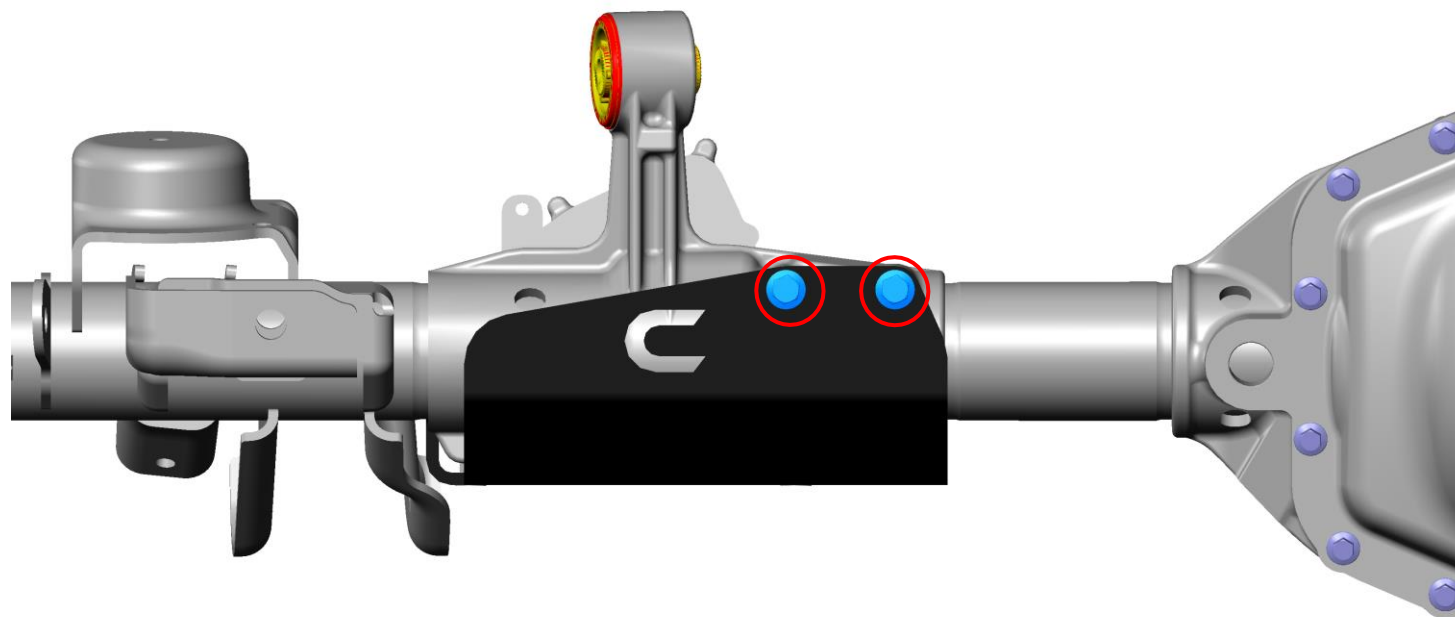

Figure 5: Factory skid plate bolts installed on new FAD skid plate (front)

INSTALLATION INSTRUCTIONS

6. Tighten down the (2) bottom flathead hex bolts first, then the remaining (4) factor bolts. Use the supplied wire tie to secure the wiring harness of the FAD motor.



Figure 6: Rear of FAD skid plate with wiring harness secured

INSTALLATION INSTRUCTIONS

7. The installation is now complete. Please review and complete the post-installation checklist before driving your vehicle.



POST-INSTALLATION CHECKLIST:

- Bottom flathead hex bolts are tightened down
- Remaining four factory skid plate bolts are tightened down
- Steering stabilizer is remounted to an aftermarket tie rod clamp
- Retorque after 500 miles of driving

